

SANGAMON COUNTY, ILLINOIS

---

ORDINANCE  
NUMBER 20-18

---

**AN ORDINANCE PROHIBITING THE USE OF GROUNDWATER AS A POTABLE  
WATER SUPPLY BY THE INSTALLATION OR USE OF POTABLE WATER SUPPLY  
WELLS OR BY ANY OTHER METHOD**

---

DAVE KIMSEY, Village President  
AMY DAHLKAMP, Village Clerk

KRISTEN CHIARO  
ANDREW DETMERS  
BRETT GERGER  
RYAN MANN  
MATT MAU  
PAUL SCHERSCHEL  
Village Trustees

---

Published in pamphlet form by authority of the President and Board of Trustees of the Village of Chatham  
on June 23, 2020

Sorling Northrup – 1 N. Old State Capitol Plaza, Suite 200, Springfield, IL 62705

47E1706-CHATHAM - GROUNDWATER ORDINANCE.DOCX 6/23/2020

**ORDINANCE NO. 20 - 18**

**AN ORDINANCE PROHIBITING THE USE OF GROUNDWATER AS A POTABLE WATER SUPPLY BY THE INSTALLATION OR USE OF POTABLE WATER SUPPLY WELLS OR BY ANY OTHER METHOD**

**WHEREAS**, the Village of Chatham (hereinafter “Village”) is an Illinois Municipal Corporation existing and operating under the Illinois Municipal Code and the laws of the State of Illinois; and

**WHEREAS**, certain properties in the Village of Chatham have been used over a period of time for commercial/industrial purposes; and

**WHEREAS**, because of said use, concentrations of certain chemical constituents in the groundwater beneath the designated parcels within the Village may exceed Class I groundwater quality standards for potable resource groundwater as set forth in 35 Illinois Administrative Code 620 or Tier 1 remediation objectives as set forth in 35 Illinois Administrative Code 742; and

**WHEREAS**, the Village of Chatham desires to limit potential threats to human health from groundwater contamination while facilitating the redevelopment and productive use of properties that are the source of said chemical constituents;

**NOW THEREFORE, BE IT ORDAINED** by the President and Board of Trustees of the Village of Chatham, Sangamon County, Illinois, as follows:

**Section 1.** Recitals. The foregoing recitals shall be and are hereby incorporated into and made a part of this Ordinance as if fully set forth in this Section 1.

**Section 2.** Use of Groundwater as a Potable Water Supply Prohibited. The use or attempted use of groundwater as a potable water supply from within the area shown on **Exhibit A**, a copy of such being attached hereto and made a part hereof, by the installation of wells or by any other

method, is hereby prohibited. This prohibition expressly applies to the Village of Chatham. **Exhibit B** contains the corresponding Parcel Identification Numbers identified in **Exhibit A**.

Any person violating the provisions of this ordinance shall be subject to a fine of not less than \$ 250.00 or more than \$ 500.00 for each violation.

As used in this Ordinance, “Person” is any individual, partnership, co-partnership, firm, company, limited liability company, corporation, association, joint stock company, trust, estate, political subdivision, or any other legal entity, or their legal representatives, agents or assigns. “Potable water” is any water used for human or domestic consumption, including, but not limited to, water used for drinking, bathing, swimming, washing dishes, or preparing foods.

**Section 3. Severability.** In the event that any section, clause, provision, or part of this Ordinance shall be found and determined to be invalid by a court of competent jurisdiction, all valid parts that are severable from the invalid parts shall remain in full force and effect.

**Section 4. Repeal and Savings Clause.** This Ordinance explicitly repeals and replaces Ordinance 19-14 “Prohibiting the Use of Groundwater as a Potable Water Supply by the Installation or Use of Potable Water Supply Wells or by Any other Method.” All Ordinances or parts of Ordinances in conflict herewith are hereby repealed; provided, however, that nothing herein contained shall affect any rights, action, or causes of action which shall have accrued to the Village of Chatham prior to the effective date of this Ordinance.

**Section 5. Effectiveness.** This Ordinance shall be in full force and effect from and after its passage, approval, and publication in pamphlet form as provided by law.

SO ORDAINED this 23 day of June, 2020, at Chatham, Sangamon County, Illinois.

	AYE	NAY	ABSTAIN	ABSENT
KRISTEN CHIARO	X			
ANDREW DETMERS	X			
BRETT GERGER			X	

RYAN MANN				X
MATT MAU	X			
PAUL SCHERSCHEL			X	
DAVE KIMSEY	X			
TOTAL	4	0	2	1

APPROVED this 23 day of June, 2020.

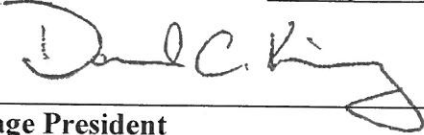
  
 \_\_\_\_\_  
 Village President

ATTEST:

  
 \_\_\_\_\_  
 Village Clerk

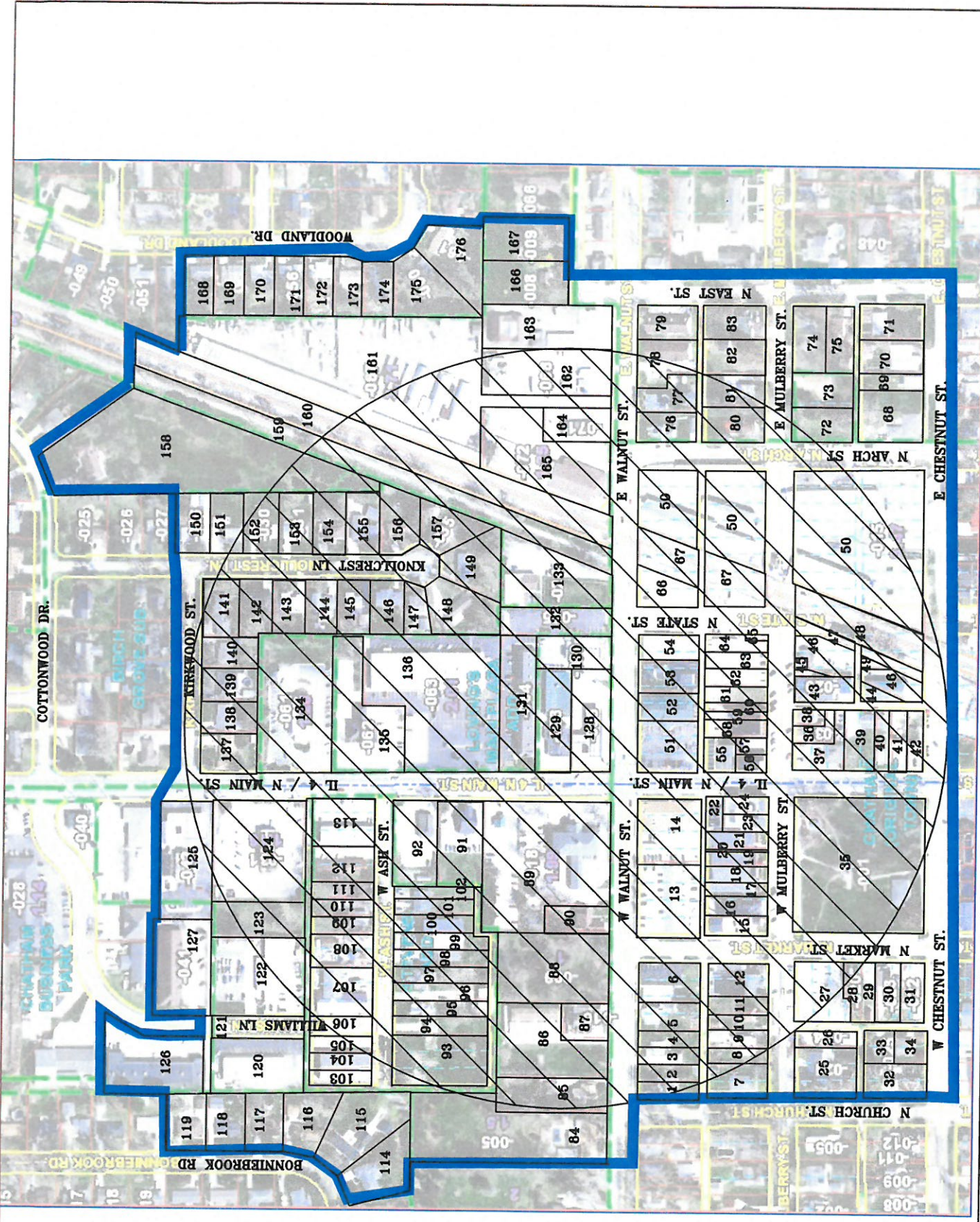

**CW<sup>2</sup>M COMPANY, INC.**  
 701 W. SOUTH GRAND  
 SPRINGFIELD, IL. 62704  
 (217) 522-8001

**CHATHAM BP**  
 CHATHAM, ILLINOIS  
 INCIDENT #07-1292  
 SANGAMON COUNTY

**GROUNDWATER**  
**ORDINANCE MAP**

**DATE: 6/11/19**  
**REVISED DATE: 4/24/20**  
**SCALE 1"=320'**  
**EXHIBIT A**

**DRAWN BY: MJS**  
**REVISED BY: JKK**  
**REVIEWED BY: CLR**

## Exhibit B

<b>Chatham Groundwater Ordinance Property Notification List</b>		
<b>Property Address</b>	<b>Parcel ID Number</b>	<b>Exhibit A Reference Guide</b>
212 West Walnut	28-12-427-001	1
-	28-12-427-002	2
208 West Walnut	28-12-427-003	3
-	28-12-427-004	4
204 West Walnut	28-12-427-018	5
200 West Walnut	28-12-427-019	6
204 Church St	28-12-427-021	7
-	28-12-427-011	8
209 West Mulberry	28-12-427-012	9
205 West Mulberry	28-12-427-013	10
-	28-12-427-014	11
201 West Mulberry	28-12-427-020	12
110 West Walnut	28-12-428-013	13
215 North Main Street	28-12-428-014	14
117 West Mulberry	28-12-428-002	15
113 West Mulberry	28-12-428-015	16
	28-12-428-005	17
	28-12-428-006	18
	28-12-428-007	19
	28-12-428-008	20
	28-12-428-009	21
211 N Main	28-12-428-010	22
	28-12-428-011	23
	28-12-428-012	24
216 West Mulberry	28-12-430-021	25
	28-12-430-004	26
151 Market Street	28-12-430-019	27
113 Market Street	28-12-430-020	28
109 Market Street	28-12-043-013	29
105 Market Street	28-12-430-023	30
201 West Chestnut	28-12-430-022	31
213 West Chestnut	28-12-430-018	32
207 West Chestnut	28-12-430-024	33
209 West Chestnut	28-12-430-025	34
100 West Mulberry	28-12-431-001	35
	29-07-304-032	36
104 E Muleberry	29-07-304-033	37
106 E Muleberry	29-07-304-031	38
120 N Main Street	29-07-304-010	39
120 N Main Street	29-07-304-011	40
100 N Main	29-07-304-012	41

	29-07-304-013	42
108 E Mulberry	29-07-304-029	43
	29-07-304-030	44
	29-07-304-020	45
	29-07-304-021	46
	29-07-304-023	47
100 N State St	29-07-509-003	48
100 N State St	29-07-504-009	49
212 E Mulberry	29-07-305-015	50
210 N Main St	29-07-301-030	51
210 N Main St	29-07-301-027	52
	29-07-301-028	53
	29-07-301-031	54
204 N Main	29-07-301-029	55
101 E Mulberry	29-07-301-017	56
	29-07-301-018	57
107 E Mulberry	29-07-301-019	58
	29-07-301-020	59
115 E Mulberry	29-07-301-021	60
	29-07-301-022	61
	29-07-301-023	62
	29-07-301-024	63
	29-07-301-025	64
	29-07-301-026	65
	29-07-302-002	66
200 N State St	29-07-509-002	67
301 E Chestnut St	29-07-306-004	68
309 E Chestnut St	29-07-306-005	69
311 Chestnut St	29-07-306-006	70
315 E Chestnut St	29-07-306-007	71
	29-07-306-011	72
306 E Mulberry St	29-07-306-010	73
119 N East St	29-07-306-008	74
115 N East St	29-07-306-009	75
302 Walnut St	29-07-303-010	76
310 Walnut Street	29-07-303-011	77
314 E Walnut St	29-07-303-003	78
209 East St	29-07-303-004	79
301 E Mulberry	29-07-303-005	80
307 E Mulberry	29-07-303-006	81
311 E Mulberry	29-07-303-015	82
315 E Mulberry	29-07-303-014	83
-----Of-----	-----Walnut-----	
303 Walnut St	28-12-280-005	84
209 W Walnut St	28-12-280-007	85
207 W Walnut St	28-12-280-017	86

205 W Walnut St	28-12-280-016	87
	28-12-280-009	88
301 N Main St	28-12-280-018	89
113 W Walnut St	28-12-280-012	90
309 N Main St	28-12-280-011	91
317 Main St	28-12-280-010	92
134 W Ash St	28-12-279-013	93
	28-12-279-004	94
	28-12-279-005	95
116 W Ash St	28-12-279-006	96
112 W Ash St	28-12-279-007	97
110 W Ash St	28-12-279-008	98
	28-12-279-009	99
	28-12-279-010	100
	28-12-279-011	101
108 W Ash St	28-12-279-012	102
207 W Ash St	28-12-278-008	103
	28-12-278-009	104
301 Williams Ln	28-12-278-010	105
	28-12-278-011	106
312 Williams Ln	28-12-278-045	107
121 Ash St	28-12-278-026	108
117 W Ash	28-12-278-017	109
117 W Ash	28-12-278-018	110
115 W Ash	28-12-278-019	111
111 W Ash St	28-12-278-027	112
325 N Main St	28-12-278-028	113
60 Bonniebrook Rd	28-12-277-022	114
58 Bonniebrook Rd	28-12-277-023	115
56 Bonniebrook Rd	28-12-277-017	116
54 Bonniebrook Rd	28-12-277-016	117
52 Bonniebrook Rd	28-12-277-015	118
50 BonnieBrook Rd	28-12-277-014	119
337 Williams Ln	28-12-277-032	120
	28-12-277-030	121
337 William Ln	28-12-278-030	122
	28-12-078-004	123
331 N Main	28-12-278-031	124
	28-12-278-042	125
349 William Ln	28-12-277-031	126
350 Williams Ln	28-12-278-041	127
300 N Main St	29-07-152-055	128
300 N Main Plaza St	29-07-152-053	129
111 E Walnut St	29-07-152-059	130
306 N Main Plaza St	29-07-152-064	131
	29-07-152-065	132



209 E Walnut St	29-07-152-024	133
490 N Main St	29-07-152-061	134
470 N Main Plaza St.	29-07-152-062	135
	29-07-152-063	136
1 Kirkwood St	29-07-152-001	137
2 Kirkwood St	29-07-152-002	138
3 Kirkwood St	29-07-152-003	139
4 Kirkwood St	29-07-152-004	140
5 Kirkwood St	29-07-152-014	141
6 Knollcrest Ln	29-07-152-015	142
7 Knollcrest Ln	29-07-152-016	143
8 Knollcrest Ln	29-07-152-017	144
9 Knollcrest Ln	29-07-152-018	145
10 Knollcrest Ln	29-07-152-019	146
11 Knollcrest Ln	29-07-152-020	147
12 Knollcrest Ln	29-07-152-021	148
13 Knollcrest Ln	29-07-152-022	149
21 Knollcrest Ln	29-07-152-028	150
20 Knollcrest Ln	29-07-152-029	151
19 Knollcrest Ln	29-07-152-030	152
18 Knollcrest Ln	29-07-152-031	153
17 Knollcrest Ln	29-07-152-032	154
16 Knollcrest Ln	29-07-152-033	155
15 Knollcrest Ln	29-07-152-034	156
14 Knollcrest Ln	29-07-152-035	157
56 Cottonwood Dr	29-07-152-048	158
	29-07-176-012	159
	29-07-509-001	160
309 E Walnut St	29-07-176-067	161
311 E Walnut St	29-07-176-068	162
315 E Walnut St	29-07-176-069	163
236 Industrial Dr	29-07-176-071	164
231 E Walnut St	29-07-176-072	165
	29-07-176-008	166
407 E Walnut St	29-07-176-009	167
409 Woodland Rd	29-07-176-053	168
403 Woodland Rd	29-07-176-054	169
349 Woodland Rd	29-07-176-055	170
343 Woodland Rd	29-07-176-056	171
337 Woodland Rd	29-07-176-057	172
331 Woodland Rd	29-07-176-058	173
325 Woodland Rd	29-07-176-059	174
319 Woodland Rd	29-07-176-060	175
600 Woodland Rd	29-07-176-061	176