

5

200

2001R65774

12-21-2001 9:18 AM

SANGAMON COUNTY
ILLINOIS

23.00
5 CHRISTIE

MARY ANN LAMM
SANGAMON COUNTY RECORDER

VILLAGE OF CHATHAM, ILLINOIS

ORDINANCE NO. 01 - 80

AN ORDINANCE ANNEXING CERTAIN PORPERTY COMMONLY KNOWN AS THE
SABINE PARCEL TO THE VILLAGE OF CHATHAM

ADOPTED BY THE PRESIDENT AND BOARD OF TRUSTEES OF THE VILLAGE OF
CHATHAM, ILLINOIS THIS 18TH DAY OF DECEMBER, 2001

Published in pamphlet form by the authority of the President and
Board of Trustees of the Village of Chatham, Sangamon County,
Illinois, this 18th day of December 2001.

RTN: RABIN, MYERS & HANKEN, P.C.
1300 S. 8TH ST.
SPFLD., IL. 62703

000107

ORDINANCE 01-80

**AN ORDINANCE ANNEXING CERTAIN PROPERTY
COMMONLY KNOWN AS THE SABINE PARCEL TO THE VILLAGE OF CHATHAM**

WHEREAS, a written petition signed by Fred and Barbara A. Sabine (collectively, the "Owners") has been filed with the Village Clerk of the Village of Chatham, Sangamon County, Illinois, requesting that certain territory be annexed to the Village of Chatham; and

WHEREAS, the Owners have represented to the Village that 100 percent of the electors residing on the territory hereinafter described have executed said written petition; and

WHEREAS, said territory is not within the corporate limits of any municipality and is contiguous to the existing corporate boundaries of the Village of Chatham; and

WHEREAS, the Village does not provide public library or provide fire protection service, therefore the Chatham Fire Protection District and the Chatham Library District need not be served with notice; and

WHEREAS, the Owners and the Village of Chatham have entered into a valid and binding annexation agreement related to such territory; and

WHEREAS, all petitions, documents and other necessary legal requirements are in full compliance with the terms of said annexation agreement and with the statutes of the State of Illinois, specifically 65 ILCS 5/7-1-8; and

WHEREAS, said territory shall be commonly known as the Sabine Parcel; and

WHEREAS, it is in the best interests of the Village of Chatham that said territory be annexed thereto.

NOW THEREFORE, BE IT ORDAINED by the President and Board of Trustees of the Village of Chatham, Sangamon County, Illinois as follows:

000108

T. 14 N. - R. 6 - 5 W

SABINE PROPERTY

SEE PAGE 19

SEE PAGE

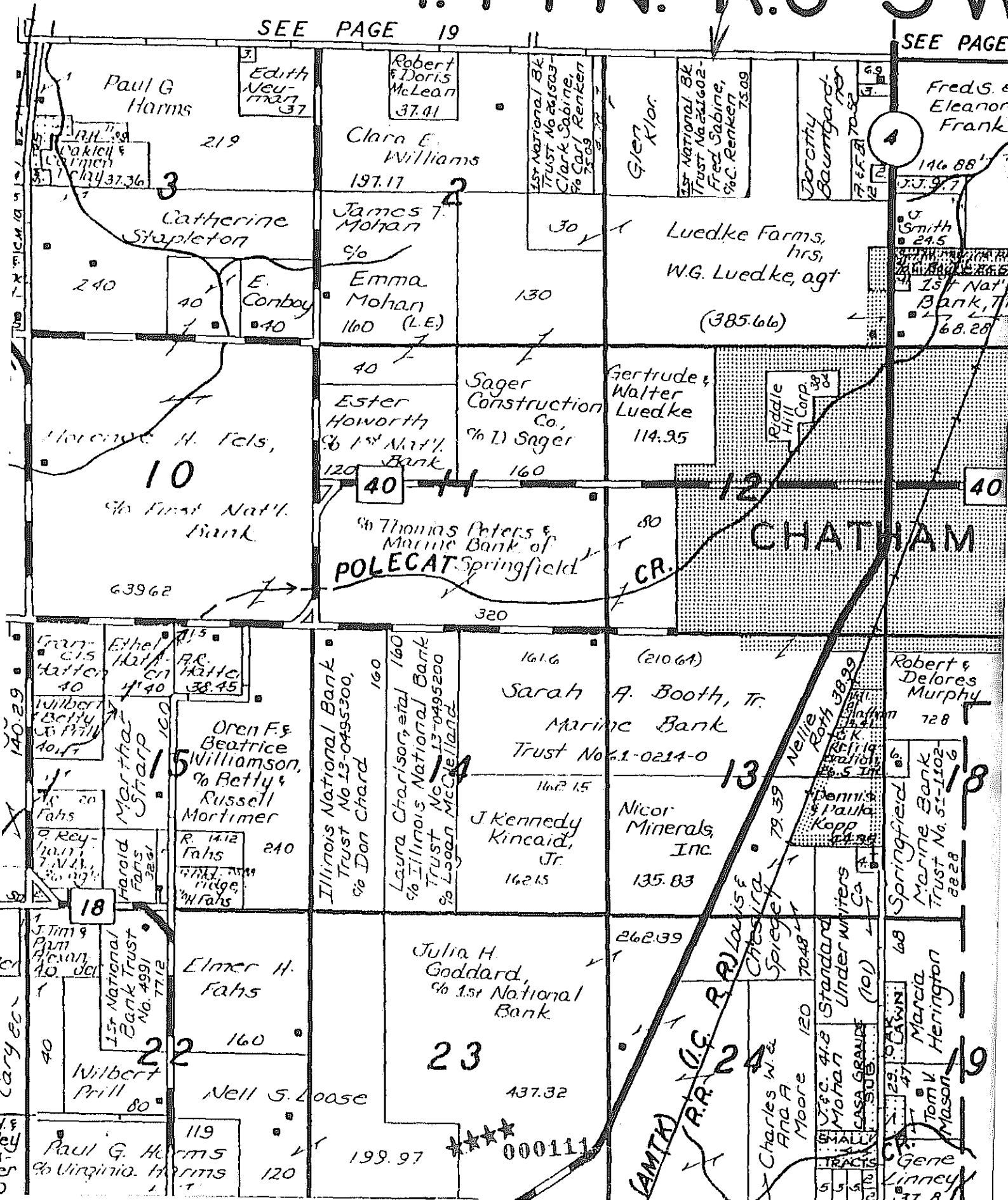

10

4

CHATHAM

POLECAT Springfield

000111

AMTA
C.S. R.
L.C. R.
A.R.

Gene Linney
37.8

SECTION 1: The following described territory be and the same is hereby annexed to and made a part of the corporate limits of the Village of Chatham, Illinois:

The East 75.095 Acres of the West 145.405 acres of the Northwest Quarter of Section 1, Township 14 North, Range 6 West of the Third Principal Meridian, all in Sangamon County, Illinois

That a Plat of Annexation of said territory is attached hereto as Exhibit A.

SECTION 2: The Village Clerk is hereby directed to record in the Office of the Recorder and to file in the Office of the County Clerk of Sangamon County, Illinois and the post office serving the territory, within 30 days of the effective date of this Ordinance, a certified copy of this Ordinance, together with Exhibit A, the Plat of Annexation.

SECTION 3: If any section, paragraph, subdivision, clause, sentence or provision of this Ordinance shall be adjudged by any court of competent jurisdiction to be invalid, such judgment shall not affect, impair, invalidate or nullify the remainder thereof, which remainder shall remain and continue in full force and effect.

SECTION 4: All ordinances or parts if ordinances in conflict herewith are hereby repealed to the extent of such conflict.

SECTION 5: This Ordinance shall be in full force and effect upon its passage, approval and publication in pamphlet form (which publication is hereby authorized) as provided by law.

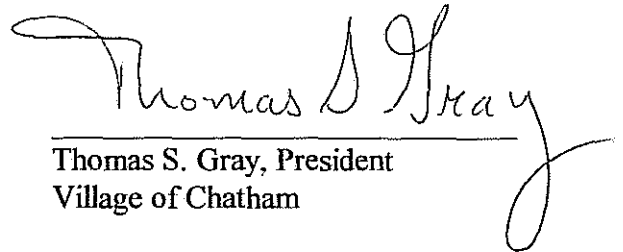
Thomas S. Gray, President
Village of Chatham



ATTEST:

Pat Schad, Village Clerk

AYES: 5
NAYS: 0
PRESENT: Mc ADAMS

PASSED: 12-18-01
APPROVED: 12-18-01
PUBLICATION: 12-18-01

CERTIFICATION

I do hereby certify that I am the duly appointed, acting and qualified Clerk of the Village of Chatham, Sangamon County, Illinois, and that as such Clerk, I am the keeper of the records and minutes and proceedings of the President and Board of trustees of said Village of Chatham.

I do further certify that at a regular meeting of the President and the Board Of Trustees of the Village of Chatham, held on the 18th day of December, 2001, the foregoing Ordinance entitles An Ordinance Annexing Certain Property Commonly Known as the Sabine Parcel to the Village of Chatham was duly passed by the President and Board of Trustees of the Village of Chatham.

The pamphlet form of Ordinance No. 01- 80, including the Ordinance and a cover sheet thereof, was prepared, and a copy of such Ordinance was available in the Village Hall, commencing the 18th day of December, 2001, and continuing for atleast 10 days thereafter. Copies of such Ordinance were also available for public inspection upon request in the office of the Clerk.

I do further certify that the original, of which the attached is a true and correct copy, is entrusted to me as the Clerk of said village for safekeeping, and that I am the lawful custodian and keeper of the same

Given under my hand and seal of the Village of Chatham this 18th day of December, 2001.

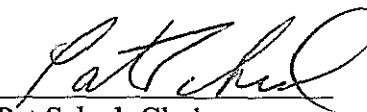

Pat Schad, Clerk
Village of Chatham

000110